

# APPENDIX A



MID SUFFOLK DISTRICT COUNCIL  
Licensing Authority  
Endeavour House, 8 Russell Road  
IPSWICH  
Suffolk IP1 2BX  
Website: [www.midsuffolk.gov.uk](http://www.midsuffolk.gov.uk)  
0300 123 4000  
Email: [licensing@midsuffolk.gov.uk](mailto:licensing@midsuffolk.gov.uk)

Licensing Act 2003

## Premises Licence Summary

# MPL0397

### POSTAL ADDRESS OF PREMISES, OR IF NONE, ORDNANCE SURVEY MAP REFERENCE OR DESCRIPTION

Cafeye  
14 Broad Street  
Eye IP23 7AF

TELEPHONE NUMBER 01379 873000

### WHERE THE LICENCE IS TIME LIMITED THE DATES

This Licence was issued with effect from: 12<sup>th</sup> August 2019

### LICENSABLE ACTIVITIES AUTHORISED BY THE LICENCE

Sale or Supply of Alcohol – ON the Premises

### THE TIMES THE LICENCE AUTHORISES THE CARRYING OUT OF LICENSABLE ACTIVITIES

#### STANDARD TIMINGS

(a) Sale or Supply of Alcohol – ON the Premises

Hours authorised: 12:00hrs until 22:00 (Monday to Sunday)

#### SEASONAL VARIATIONS / NON-STANDARD TIMINGS

N/A

# APPENDIX A

## THE OPENING HOURS OF THE PREMISES

### **STANDARD TIMINGS**

**Hours authorised:** 08:00hrs until 23:00 (Monday to Sunday)

### **SEASONAL VARIATIONS / NON-STANDARD TIMINGS**

N/A

## WHERE THE LICENCE AUTHORISES SUPPLIES OF ALCOHOL WHETHER THESE ARE ON AND / OR OFF SUPPLIES

### **Sale or Supply of Alcohol – ON the Premises**

## NAME, (REGISTERED) ADDRESS OF HOLDER OF PREMISES LICENCE

Cem Cilfaoglu  
3 Mere Manor Court  
Diss  
IP22 4WX

## REGISTERED NUMBER OF HOLDER, FOR EXAMPLE COMPANY NUMBER, CHARITY NUMBER (WHERE APPLICABLE)

**Registered company number: N/A**

## NAME OF DESIGNATED PREMISES SUPERVISOR WHERE THE PREMISES LICENCE AUTHORISES THE SUPPLY OF ALCOHOL

**Turan Cilfaoglu**

## STATE WHETHER ACCESS TO THE PREMISES BY CHILDREN IS RESTRICTED OR PROHIBITED

### **A. By virtue of section 145 of the Licensing Act 2003:**

(i) Children under the age of 16, that are not accompanied by an individual aged 18 or over, are not permitted to be on the premises at a time whilst the premises is open and being used exclusively or primarily for the supply of alcohol for consumption on the premises.

(ii) Children under the age of 16, that are not accompanied by an individual aged 18 or over, are not permitted to be on the premises between the hours of midnight and 5am whilst the premises is open and being used for purposes including the supply of alcohol for consumption on the premises.

**AUTHORISED OFFICER**  
MPL0397

# APPENDIX A



MID SUFFOLK DISTRICT COUNCIL  
Licensing Authority  
Endeavour House, 8 Russell Road  
IPSWICH  
Suffolk IP1 2BX  
Website: [www.midsuffolk.gov.uk](http://www.midsuffolk.gov.uk)  
0300 123 4000: l  
licensing@midsuffolk.gov.uk

Licensing Act 2003

## Premises Licence

# MPL0397

### Part 1 - Premises Details

#### POSTAL ADDRESS OF PREMISES, OR IF NONE, ORDNANCE SURVEY MAP REFERENCE OR DESCRIPTION

Cafeye  
14 Broad Street  
Eye IP23 7AF

#### TELEPHONE NUMBER

01379 873000

#### WHERE THE LICENCE IS TIME LIMITED THE DATES

This Licence was issued with effect from: 12<sup>th</sup> August 2019

#### LICENSABLE ACTIVITIES AUTHORISED BY THE LICENCE

- Sale or Supply of Alcohol – ON the Premises

# APPENDIX A

## THE TIMES THE LICENCE AUTHORISES THE CARRYING OUT OF LICENSABLE ACTIVITIES

### STANDARD TIMINGS

#### (a) Sale or Supply of Alcohol – ON the Premises

Hours authorised: 12:00hrs until 22:00 (Monday to Sunday)

### SEASONAL VARIATIONS / NON-STANDARD TIMINGS

N/A

## THE OPENING HOURS OF THE PREMISES

### STANDARD TIMINGS

Hours authorised: 08:00hrs until 23:00 (Monday to Sunday)

### SEASONAL VARIATIONS / NON-STANDARD TIMINGS

N/A

## WHERE THE LICENCE AUTHORISES SUPPLIES OF ALCOHOL WHETHER THESE ARE ON AND / OR OFF SUPPLIES

**Sale or Supply of Alcohol – ON the Premises**

# APPENDIX A

## Part 2

NAME, (REGISTERED) ADDRESS, TELEPHONE NUMBER AND E-MAIL (WHERE RELEVANT) OF HOLDER OF PREMISES LICENCE

Cem Cilfaoglu  
3 Mere Manor Court  
Diss  
IP22 4WX

REGISTERED NUMBER OF HOLDER, FOR EXAMPLE COMPANY NUMBER, CHARITY NUMBER (WHERE APPLICABLE)

**Registered company number: N/A**

NAME, ADDRESS AND TELEPHONE NUMBER OF DESIGNATED PREMISES SUPERVISOR WHERE THE PREMISES LICENCE AUTHORISES THE SUPPLY OF ALCOHOL

**Turan Cilfaoglu**

PERSONAL LICENCE NUMBER AND ISSUING AUTHORITY OF PERSONAL LICENCE HELD BY DESIGNATED PREMISES SUPERVISOR WHERE THE PREMISES LICENCE AUTHORISES FOR THE SUPPLY OF ALCOHOL

**Personal Licence number: 901**  
**Issued by: South Norfolk District Council**

AUTHORISED OFFICER  
MPL0397



# APPENDIX A



## CONDITIONS ATTACHED TO THE ISSUE OF: PREMISES LICENCE MPL0397

---

### **ANNEX 1 - MANDATORY CONDITIONS**

The following conditions in Annex 1 are mandatory under the provisions of the Licensing Act 2003:

- 1.1 Alcohol shall not be sold or supplied:
  - (a) At any time when there is no designated premises supervisor in respect of the premises licence, or
  - (b) At any time when the designated premises supervisor does not hold a personal licence or his/her personal licence is suspended
- 1.2 Every sale or supply of alcohol under the premises licence must be made or authorised by a person who holds a personal licence.
- 1.3 The responsible person must ensure that staff on relevant premises do not carry out, arrange or participate in any irresponsible promotions in relation to the premises.

In this paragraph, an irresponsible promotion means any one or more of the following activities, or substantially similar activities, carried on for the purpose of encouraging the sale or supply of alcohol for consumption on the premises -

- (a) games or other activities which require or encourage, or are designed to require or encourage, individuals to -
  - (i) drink a quantity of alcohol within a time limit (other than to drink alcohol sold or supplied on the premises before the cessation of the period in which the responsible person is authorised to sell or supply alcohol), or
  - (ii) drink as much alcohol as possible (whether within a time limit or otherwise);
- (b) provision of unlimited or unspecified quantities of alcohol free or for a fixed or discounted fee to the public or to a group defined by a particular characteristic in a manner which carries a significant risk of undermining a licensing objective;
- (c) provision of free or discounted alcohol or any other thing as a prize to encourage or reward the purchase and consumption of alcohol over a period of 24 hours or less in a manner which carries a significant risk of undermining a licensing objective;
- (d) selling or supplying alcohol in association with promotional posters or flyers on, or in the vicinity of, the premises which can reasonably be considered to condone, encourage or glamorise anti-social behaviour or to refer to the effects of drunkenness in any favourable manner;
- (e) dispensing alcohol directly by one person into the mouth of another (other than where that other person is unable to drink without assistance by reason of disability).

# APPENDIX A

- 1.4 The responsible person must ensure that free potable water is provided on request to customers where it is reasonably available.
- 1.5 (a) The premises licence holder or club premises certificate holder must ensure that an age verification policy is adopted in respect of the premises in relation to the sale or supply of alcohol.
- (b) The designated premises supervisor in relation to the premises licence must ensure that the supply of alcohol at the premises is carried on in accordance with the age verification policy.
- (c) The policy must require individuals who appear to the responsible person to be under 18 years of age (or such older age as may be specified in the policy) to produce on request, before being served alcohol, identification bearing their photograph, date of birth and either -
- (i) a holographic mark, or
  - (ii) an ultraviolet feature.
- 1.6 The responsible person must ensure that -
- (a) where any of the following alcoholic drinks is sold or supplied for consumption on the premises (other than alcoholic drinks sold or supplied having been made up in advance ready for sale or supply in a securely closed container) it is available to customers in the following measures -
- (i) beer or cider: ½ pint;
  - (ii) gin, rum, vodka or whisky: 25 ml or 35 ml; and
  - (iii) still wine in a glass: 125 ml;
- (b) these measures are displayed in a menu, price list or other printed material which is available to customers on the premises; and
- (c) where a customer does not in relation to a sale of alcohol specify the quantity of alcohol to be sold, the customer is made aware that these measures are available.
- 1.7 The relevant person (the holder of the premises licence, the designated premises supervisor (if any) in respect of such a licence, the personal licence holder who makes or authorises a supply of alcohol under such a licence, or any member or officer of a club present on the premises in a capacity which enables the member or officer to prevent the supply in question) shall ensure that no alcohol is sold or supplied for consumption on or off the premises for a price which is less than the permitted price.

For the purposes of this condition “duty” is to be construed in accordance with the Alcoholic Liquor Duties Act 1979, “permitted price” is the price found by applying the formula -

$$P = D + (D \times V)$$

where - (i) **P** is the permitted price, (ii) **D** is the rate of duty chargeable in relation to the alcohol as if the duty were charged on the date of the sale or supply of the alcohol, and (iii)

**V** is the rate of value added tax chargeable in relation to the alcohol as if the value added tax were charged on the date of the sale or supply of the alcohol;

[“value added tax” means value added tax charged in accordance with the Value Added Tax Act 1994]

# APPENDIX A

## **ANNEX 2 - CONDITIONS CONSISTENT WITH THE OPERATING SCHEDULE**

The following conditions in Annex 2 are conditions consistent with the operating schedule submitted by the applicant within the application

The premises licence holder shall ensure that all members of staff are trained in the basic law relating to the sale and supply of alcohol.

The premises licence holder shall adopt a 'challenge 25' proof of age scheme. The premises licence holder shall operate a requirement for the production of a passport, uk photocard driving licence or pass accredited photocard, where the individual requesting the supply of alcohol appears to be under the age of 25.

During operating hours, the premises licence holder or a nominated representative shall be available to receive and respond to nuisance-related complaints via a contact telephone number.

Staff shall monitor the activity of customers leaving the premises and remind them to act in a responsible manner and consider the needs of neighbours.

The installation of cctv will enable close monitoring of activities in the licenced premises.

Contact details of local licensed taxi and private hire operators shall be made available for customers at the licensed premises.

The premises licence holder shall ensure that, during hours of darkness, whilst the premises are being used for licenceable activities, the premises shall be adequately illuminated.

All internal (including toilets) and external areas shall be monitored by staff on duty whilst premises are being used for licenceable activities.

Signage shall be clearly and prominently displayed at all entrance and exit points on the licensed premises, requesting customers to minimise noise (both verbal and vehicular) when leaving, in consideration of the local residents.

Monitoring shall take place both inside and outside the licenced premises with appropriate remedial steps taken in the event of nuisances experienced.

The sale and consumption of alcohol shall cease by 22:00hrs.

The premises licence holder shall ensure that adequate provision is made for the collection and disposal of waste and litter at the licenced premises. There will be suitable and sufficient lidded waste disposal bins provided at the licenced premises.

Children shall be accompanied by a responsible adult at all times when in areas that are being used for licenced activities of sale and consumption of alcohol.

There shall be no adult entertainment ancillary to the use of the premises that may give rise to concern in respect of children.



# APPENDIX A

## ANNEX 3 - CONDITIONS ATTACHED AFTER A HEARING BY THE LICENSING AUTHORITY

N/A

## ANNEX 4 - PLANS

Attached

AUTHORISED OFFICER

MPL0397



# APPENDIX A

## First Floor Plan

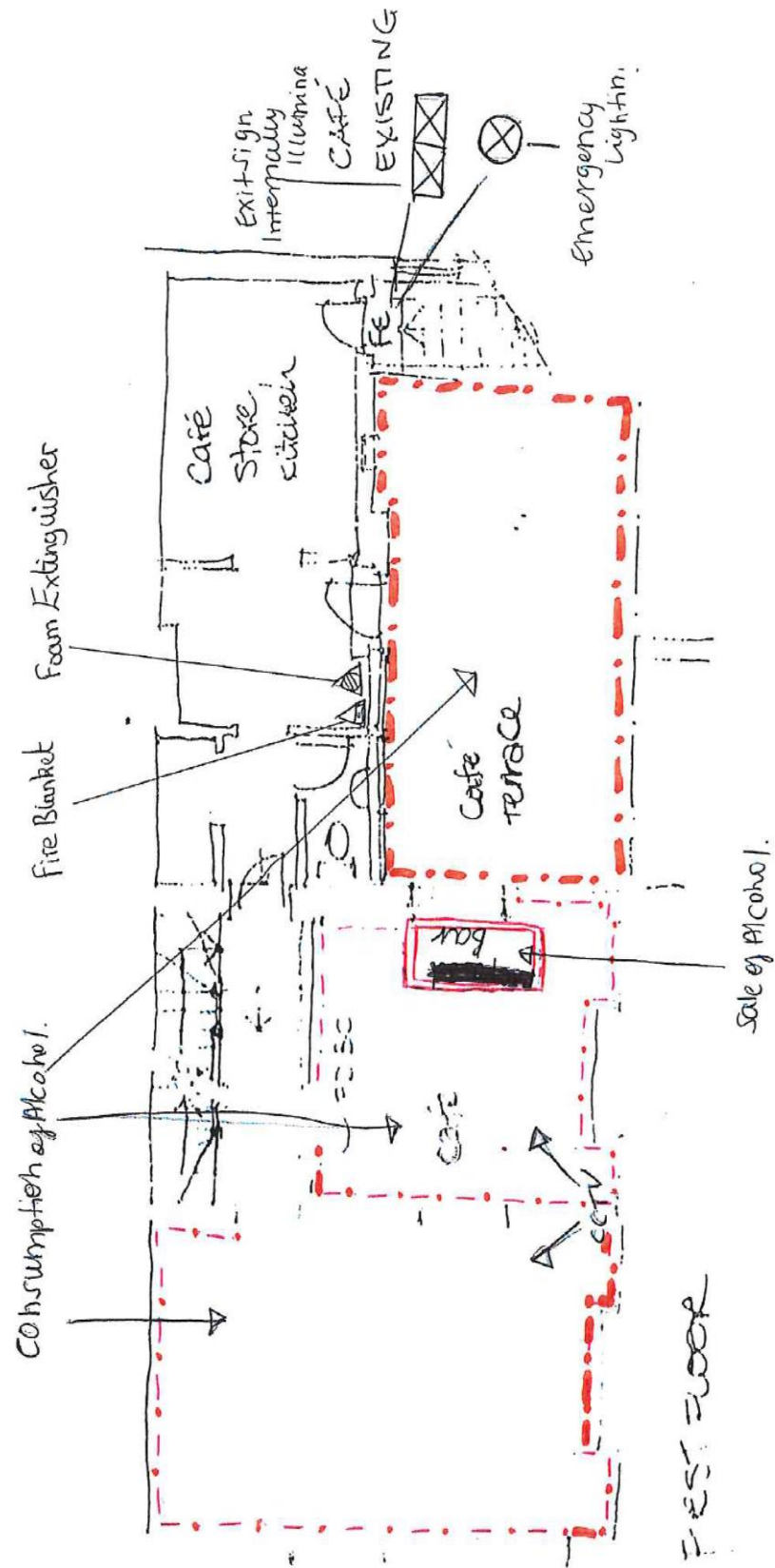

# APPENDIX A

## Ground Floor Plan

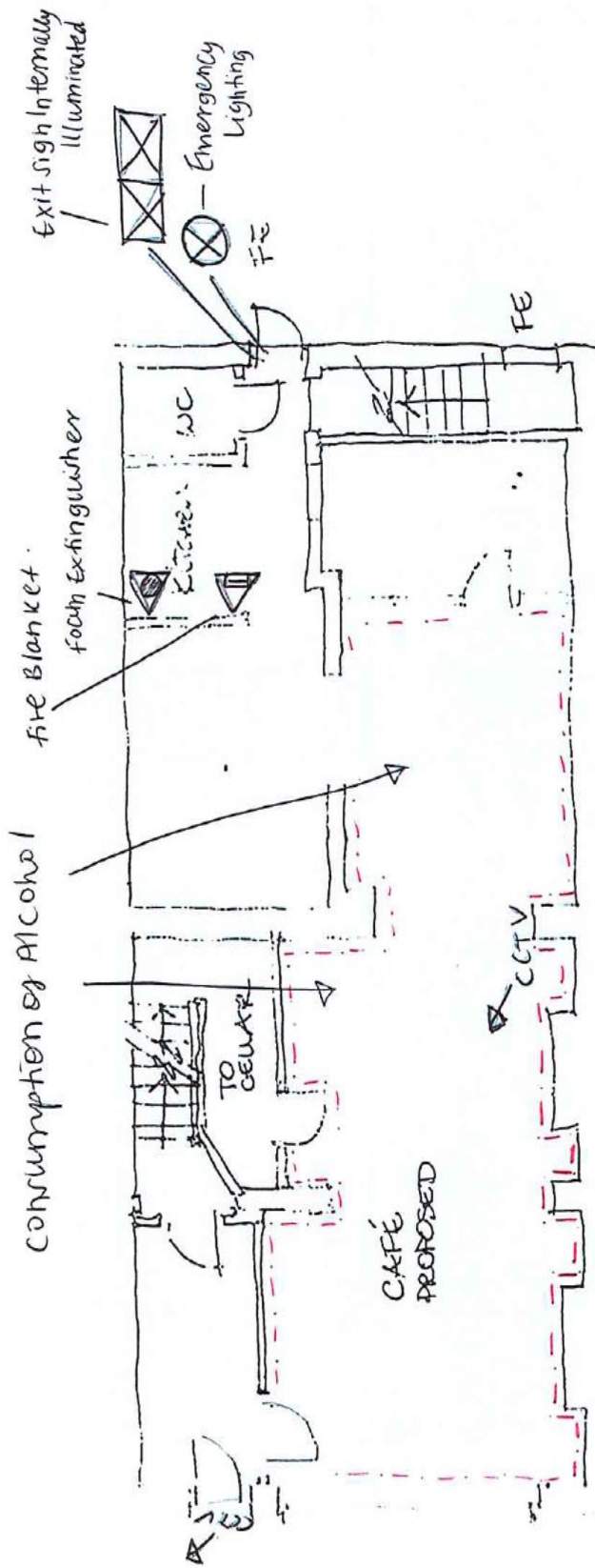

### KEY: GROUND FLOOR

- ▣ Fire Blanket
- ▣ foam extinguisher
- ⊗ Emergency lighting
- ⊗ Exit Sign Internally Illuminated
- - - Consumption of Alcohol
- Sale of Alcohol
- FE fire exit

### B. REYS NOTES (NO CHANGE C)

1. FIRE ALARM & EMERGENCY LIGHTING THROUGHOUT TO BE TESTED & CERTIFIED
2. REPAIR TO GARAGE DOOR